

71 — 3.52 — 2.14⁵

71 — 69⁵ — 2.51 — 2.94

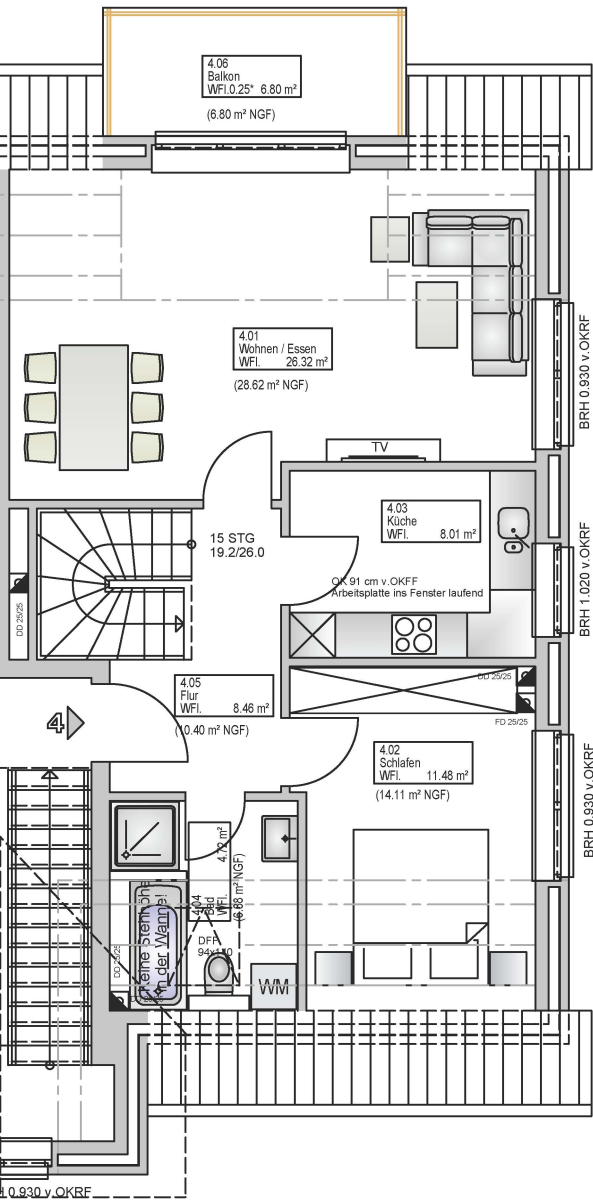

2.20⁵ — 1.88⁵ — 1.33 — 1.34⁵ — 1.13⁵ — 1.34⁵ — 1.33 — 2.20⁵ — 3.86⁵ — 44

11⁵ — 1.24 — 1.15 — 2.47⁵ — 11⁵

44 — 4.55 — 2.47⁵

26 — 1.31⁵ — 5.55⁵ — 33